



26 Debono Drive Miners Rest VIC

3 2 2

Welcome to "MacArthur Park Estate". This popular family friendly estate boasts beautiful parklands, walking tracks, as well as a playground with BBQ area. It is conveniently located with easy freeway access, a short 5 minute drive to Stockland's shopping centre and the Ballarat CBD reachable in a 10 minute drive.

This gorgeous home is set on a huge 682SQM (approx.) allotment providing ample room to securely store caravans, boats and cars via the side access. Upon entry the first thing you will notice is the massive front formal lounge. Moving down the hall towards the rear of the home you will find the huge open plan kitchen/meals/living area as well as the large study leading off from this zone. In this hub of the home is the well-appointed kitchen with great corner pantry, gas cooktop/oven, dishwasher and a fridge spot able to accommodate two large side by side fridges.

Price : \$ 600,000
Land Size : 682 sqm
View : <https://www.doepels.com.au/sale/vic/ballarat-western-district/miners-rest/residential/house/7342809>



Peter Wekerle
03 5331 2000

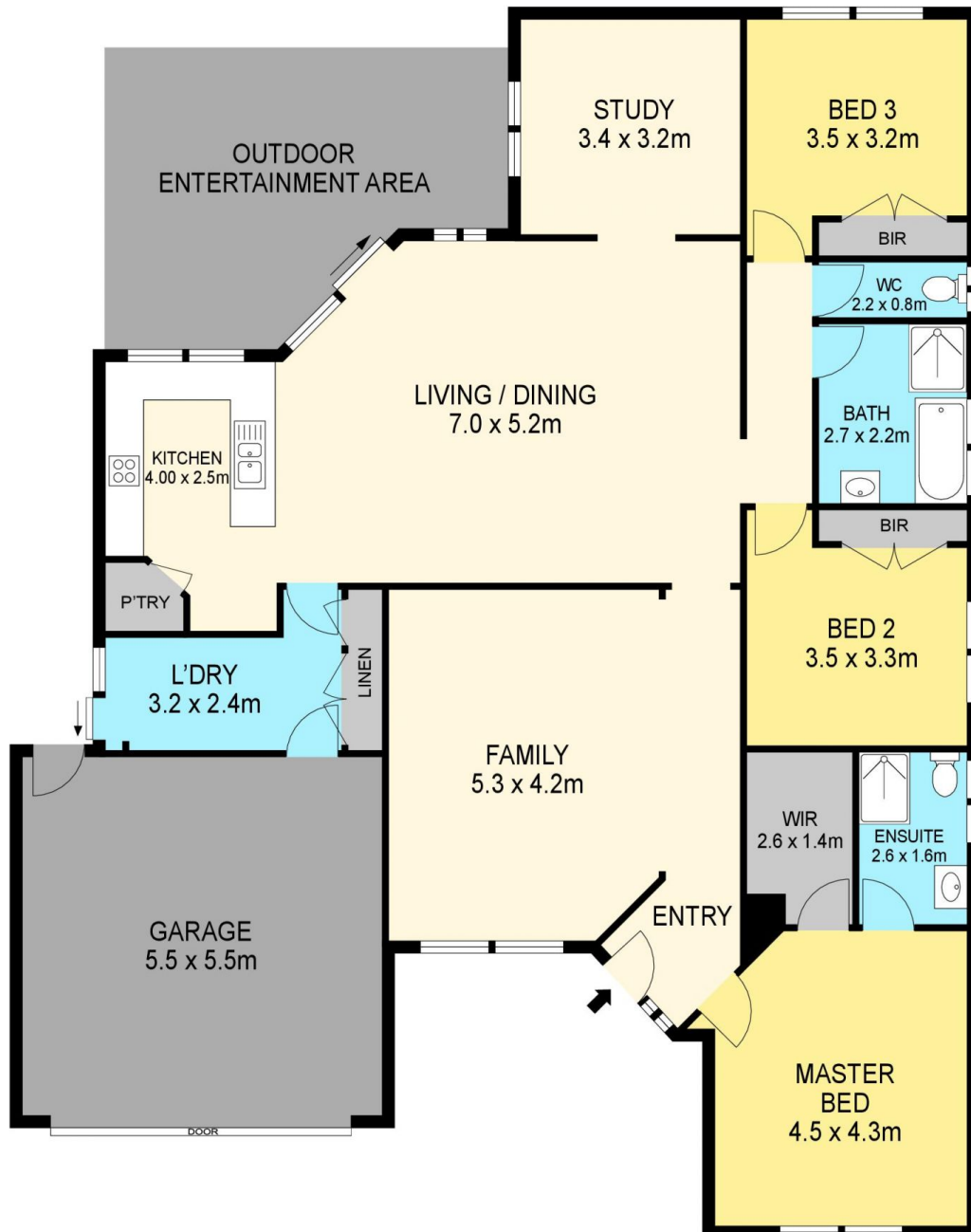

DISCLAIMER

PLANS SHOWN ARE FOR MARKETING PURPOSES ONLY, ALL DIMENSIONS ARE APPROXIMATE AND NOT TO SCALE. THEY ARE SUBJECT TO ERRORS AND INACCURACIES AND NO LIABILITY WILL BE ACCEPTED. INTERESTED PARTIES SHOULD MAKE THEIR OWN INQUIRES.