

LARGE FAMILY HOME

OVER 290SQM UNDER ROOF



38 Faversham Avenue Lake Gardens VIC

4 2 2

Your search is over - here is the large family home you have been seeking. Well positioned in one of Ballarat's most desirable estates close to beautiful Lake Wendouree and the Botanic Gardens, Wendouree train station and renowned shopping facilities, Aquatic centre, Ballarat High School zone and of course the private school sector. Four large bedrooms, separate study, excellent robe space to all bedrooms and large ensuite to the main. Impressive double door entry, 3 enormous living areas and a very well appointed and spacious family meals area. Walk in pantry, 900mm hotplates, ducted heating and cooling, ducted vacuum system, security system, high ceilings, sunblinds, light, bright and airy in all rooms, walk in linen/general storage etc. Wonderful gardens with paved alfresco area, and drive through access from the double garage. Position perfect, presentation perfect - make it your new home today!

Price : \$ 605,000
Land Size : 666 sqm
View : <https://www.doepels.com.au/sale/vic/ballarat-western-district/lake-gardens/residential/home/6188170>



John Morris
03 5331 2000



Leigh Hutchinson
03 5331 2000

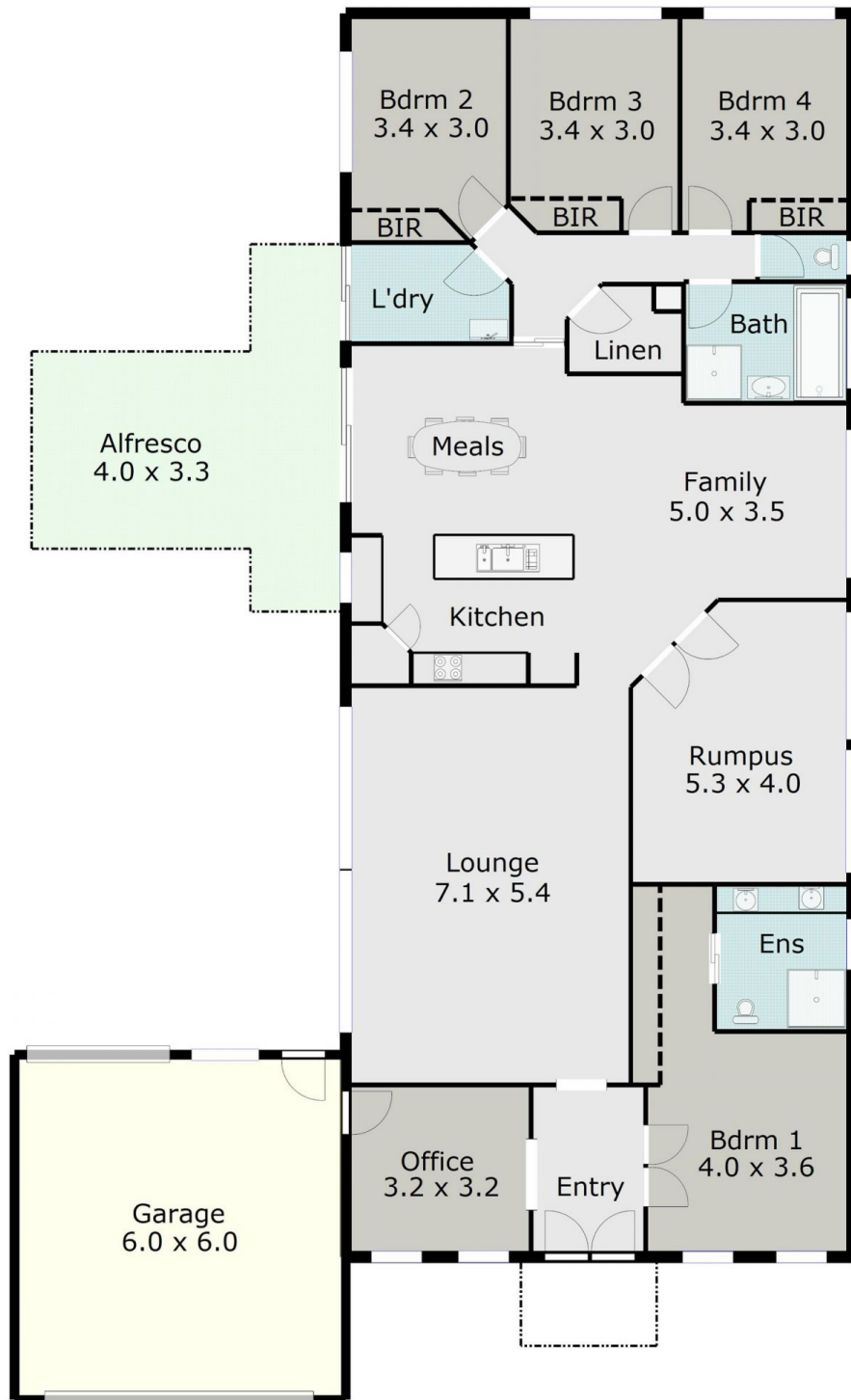

DISCLAIMER:

ALL DIMENSIONS ARE APPROXIMATE & NOT 100% TO SCALE.
 FOR FURTHER INFORMATION, PLEASE CONTACT YOUR AGENT DIRECTLY.

